

# PACIFIC HYDRAULIC RECOVERY WINCH

## Dimensions

mm	HV8000	HV10000	HV12000	HV15000
A	190	253	255	255
B	228.6	291.6	303.5	303.5
C	311.2	374.2	368.5	368.5
D	556.8	622.9	684	684
F	251	253.5	276	276
G	114.3	114.3	114.3	114.3
H	171.2	171.2	171.2	171.2
I	209	209	209	209

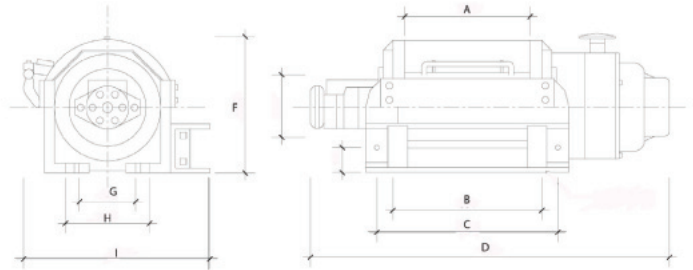

\*this is a guide only, each model differs slightly

## Specifications

Model	Line Pull	Line Speed	Drum Capacity	Gear Ratio	Winch Weight
HV8000	5629 kg	15mpm	10mm x 40m	16:1	36kg
HV10000	4535 kg	12mpm	10mm x 40m	16:1	37kg
HV12000	5443 kg	11mpm	12mm x 40m	19.4:1	70kg
HV15000	6803 kg	9mpm	14mm x 27m	10:1	70kg

\*not supplied with wire rope

\*\* New models HV20000 & HV30000 details available upon request

## Additional Information

<b>Operation pressure</b>	140 bar
<b>Maximum Oil Flow</b>	15.9g / min
<b>Motor Rotation</b>	Anti-clockwise
<b>Gear Train</b>	2 stage planetary gear
<b>Clutch</b>	Rotating ring gear
<b>Brake</b>	Cone load-holding
<b>Drum Size</b>	127mm x 255mm
<b>Box Dimensions</b>	762 x 415 x 311mm

